



## Discover our range of concealed panel / door locks

Panel locks, also called butt joints or coffin locks, are used to lock platforms, panels or decks together.

It consists of two parts (latch and receptacle) that progressively draws two panels together. It is operated with a hex wrench (sold separately).

Our panel locks are heavy-duty and have high tensile load strength.

# Concealed Panel / Door Locks



## 9274

**Mounting Style:** Mortise or Side Mount

**Lock Style:** Hook Lock

**Material:** Steel, Zinc Plated

**Installation:** 1/4" Dia., M6 Screws / 1/4" Dia. Rivets (Not Supplied)

**Load Rating:** 1000Kg / 2204Lb

**Accessories:** Actuation Tool (Part #9608)

### Lock Drawing

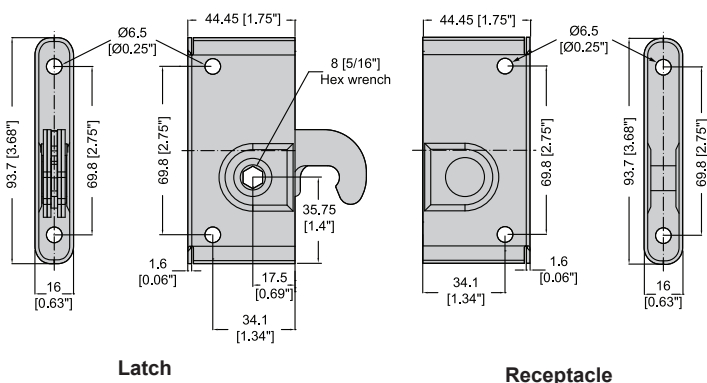

### Panel Installation

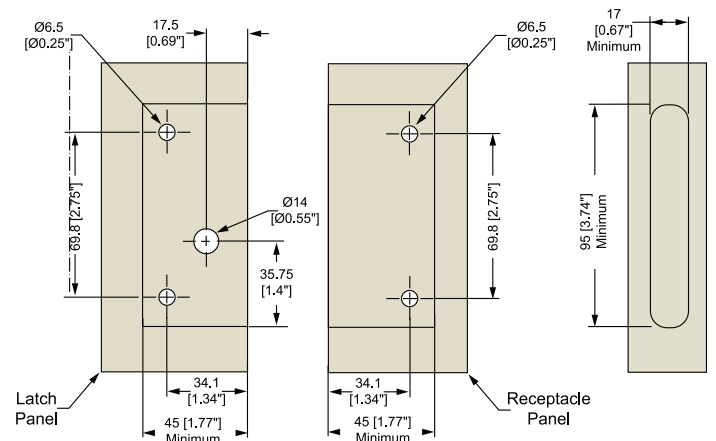



# 9284

**Mounting Style:** Mortise or Side Mount

**Lock Style:** Rotary Lock

**Material:** Steel, Zinc Plated

**Installation:** 1/4" Dia. or M6 Screws / 1/4" Dia. Rivets (Not Supplied)  
A 1.6mm gap should be maintained between the latch and receptacle

**Load Rating:** 700Kg / 1543Lb

**Accessories:** Actuation Tool (Part #9608)

## Lock Drawing

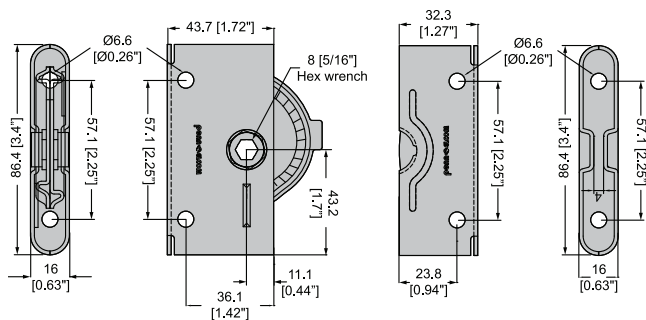

Latch

Receptacle

## Panel Installation

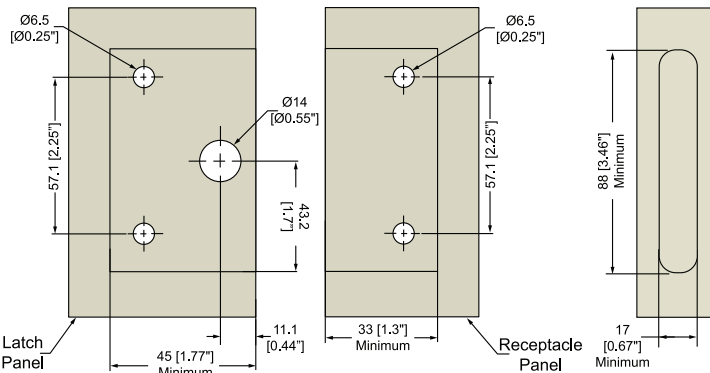

Latch Panel

Receptacle Panel



# 9280

**Mounting Style:** Mortise or Side Mount

**Lock Style:** Rotary Lock

**Material:** Steel, Zinc Plated

**Installation:** 1/4" Dia. or M6 Screws / 1/4" Dia. Rivets (Not Supplied)  
A 1.6mm gap should be maintained between the latch and receptacle

**Load Rating:** 700Kg / 1543.24Lb

**Accessories:** Actuation Tool (Part #9608)

## Lock Drawing

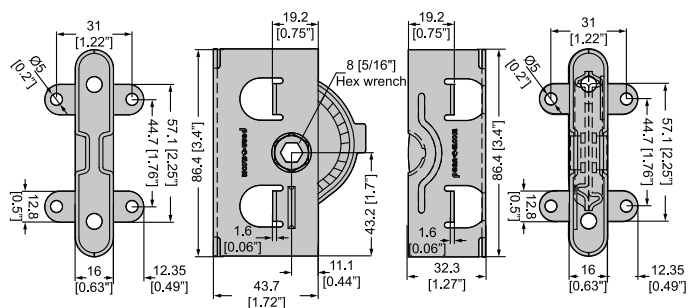

Latch

Receptacle

## Panel Installation

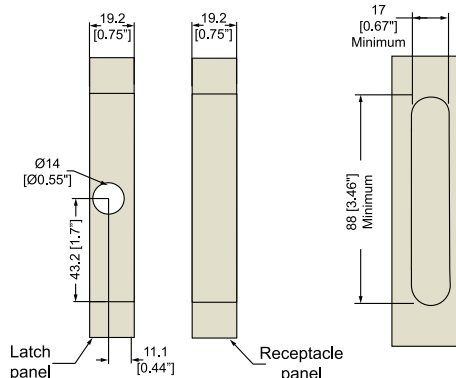

Latch panel

Receptacle panel



**Accessories:** Actuation Tool (Part #9608)

### Receptacle

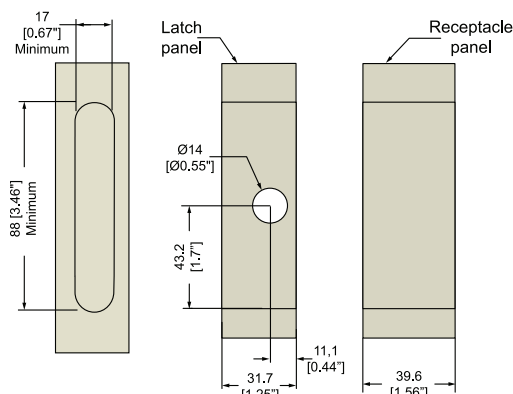

**Accessories:** Actuation Tool (Part # 9608)

Receptacle

