

PDU01-14

20A SURGE & EMI FILTERED AC/DC PDU



1U Rack Mounting PDU with Surge Protection & EMI Filter

1U high Horizontal Mounting Unit is designed to provide a versatile hook-up for the distribution of AC & DC power within multimedia racking applications.

- Input** **Power Con** EMI filtered input with protection against Lightning Strike & Local Power Surge. 20A T inline internal fuse.
- Output AC~** 8 x **IEC320 C13** in 2 banks of 4 with a Maximum Combined Load 20A
- Protection** 2 x 10 AMP Circuit Breaker Switches
- DC PSU** Switchable **Isolated** Universal DC supply fully protected (AC input range 88V~264V)
- Output DC-** 12 Way **Pluggable** Screw Terminal Socket
3 x 5V dc
3 x 12V dc
With a Max Combined Load of 65W
- Earth Link** Thumb Screw Terminal for Rack Grounding
- Usage**
 - Nominal Voltage: 230V
 - Usable Voltages 200V~ 240V full range
 - Frequency: 50/60HZ full range
 - Max. A/C Output: Current 20A
 - Case Size: 45 x 140 x 430mm (O.A.483mm)
 - Weight: 2Kg
- Compliance** All components used in this conform to current RoHS, CE & UL certification
(**EMI**:EN55022 (CISPR22) Class B; EN61000-3-2,3 **EMS**:EN61000-4-2,3,4,5,6,8,11; Light industry level, criteria A)



penn-elcom[®]

Designed & Made in the UK by Penn Elcom Ltd

9-10 Parsons Road, Parsons Industrial Estate, Washington Tyne & Wear, NE37 1HB, UK
0191 416 1717 or www.penn-elcom.com

Your Kit Includes

- 6 Green 2 Way Terminal Plugs
- 1 Blue Neutrik powerCON Plug

RED Neon Indicators

on the trip switches will show there is AC power in the unit.
Should these be **OFF** then -
1st check the power is connected
2nd check the internal line fuse

PLEASE NOTE:

*In the event of a Power Surge or Lightning Strike the **ultrafast** protection circuit will be activated.*

This will result in a blown fuse

*To replace this fuse disconnect the supply remove the lid and fit a new **20A T 20mm** fuse into the holder*

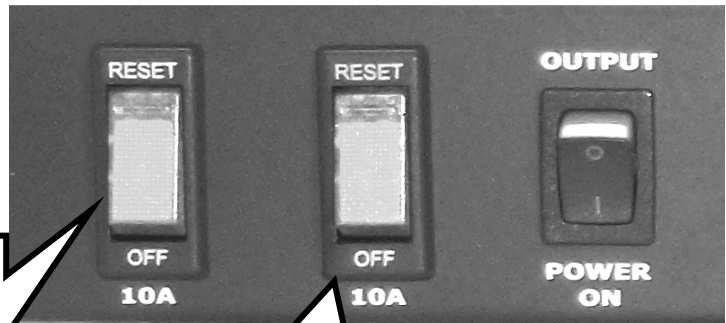

10A Trip Switches for banks 1 & 2
In the event of overload these will cut power to the

DC Power Supply Switch
Activates the 5 & 12V DC outputs

AC~Outputs
2 Banks of 4 C13 sockets
Each with max load of 10A for use with C14 Connectors

Earth Strap Point
For attachment to the rack unit

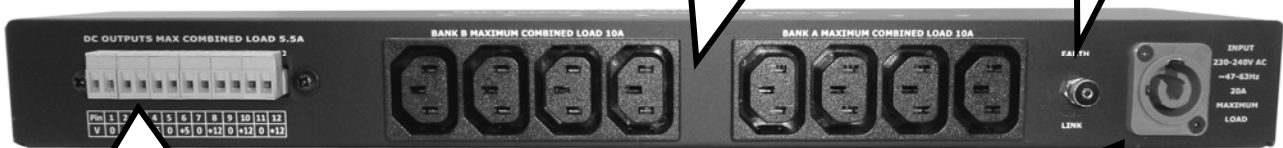

DC Outputs 65W Max

3 x **5V** and 3 x **12V**
Plug-in screw terminals are used as shown here

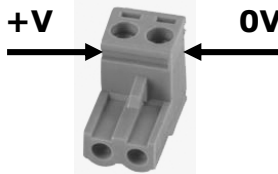

When connecting outputs are consecutively numbered
1-2, 3-4, 5-6 = 5V
7-8, 9-10, 11-12 = 12V
This is an isolated supply
0V is not Ground

AC Power Input

A Neutrik powerCON Connector is supplied for A/C power input.

FOR 20A USE THIS UNIT MUST BE USED WITH 2.5mm DIA 20A CABLE AND CONNECTED TO A SUITABLE OUTPUT SUPPLY



PLEASE NOTE

FITTING A 13A PLUG WILL REDUCE THE OVERALL POWER RATING E&OE

19 INCH RACK MOUNT POWER DISTRIBUTION UNIT OPERATION & USER GUIDE

**Please read the following information before installing or
using your Power Distribution Units**

Safety and Grounding (earth)

- This PDU is intended for indoor use only.
- Do not install this PDU where excessive moisture or heat is present.
- Never install any wiring, equipment, or PDU's during a lightning storm.
- Always connect this PDU into a three-wire, grounded power outlet.
- The power input cable should be connected to appropriate branch circuit/mains protection (fuse or circuit breaker). Connection to any other type of power outlet may result in a shock hazard.
- Use only the supplied brackets for mounting.
- Never work alone under hazardous conditions.
- Check that the power cord, plug, and socket are in good condition.
- Disconnect the PDU from the power outlet before you install or connect equipment to reduce the risk of electric shock if you cannot verify grounding. Reconnect the PDU to the power outlet only after you have made all connections.
- Use a protective earth connector with equipment. This type of connector carries the leakage current from the load devices (computer equipment). Do not exceed a total leakage current of 3.5mA or a risk of electrical shock will result.
- Use the Stud Earth point on the back of the PDU to directly ground to the rack.
- ALWAYS make sure the equipment that has been connected to the PDU is **OFF**, before switching on the PDU, as the **Inrush Current** can blow the power fuse and activate the protection circuit.
- All equipment plugged into this unit should have the correct fuses fitted for their current draw.
- Penn Elcom Ltd accepts no responsibility or liability for any equipment connected to this unit

GUARANTEE

YOUR EQUIPMENT IS GUARANTEED FOR A PERIOD OF ONE YEAR FROM THE DATE OF PURCHASE OF THE PRODUCT AGAINST ANY DEFECTS DUE TO FAULTY MATERIALS OR FAULTY MANUFACTURING. DURING THIS PERIOD, REPLACEMENT OR REPAIR TO THE UNIT WILL BE MADE WITHOUT CHARGE BY ANY AUTHORISED DEALER OR THE FACTORY SUBJECT TO THE FOLLOWING CONDITIONS.

The fault must be entirely due to faulty materials or faulty manufacture.

*The defect must **NOT** have been caused by poor installation, accidental damage, misuse or failure to comply with the instructions given in the users guide.*

If at any time during the guarantee period a part or parts of the equipment are repaired with a part or parts not supplied or approved by us; or if the equipment has been dismantled or repaired by any person not authorised by the us, then the guarantee shall immediately cease and become void.

Evidence of the date of purchase must be produced at the service point to obtain the benefit of this guarantee. Any carriage charges relating to the guarantee will be the responsibility of the purchaser.

This guarantee applies to the original purchaser only and the equipment must have been purchased or financed from new, this guarantee cannot be assigned or transferred.

The company reserves the right to replace the equipment or repair it at their discretion, any defective part shall become the property of the company.

This guarantee applies to equipment purchased and used within the E.E.C. The importers of equipment in non E.E.C. countries are responsible for the guarantee of this unit. Parts required under guarantee are free. Shipping charges for components will be charged at cost.

The guarantee shall become void if the equipment is at anytime used on any supply circuit or voltage range other than that specified on the equipment.

12. THIS GUARANTEE DOES NOT IN ANY WAY AFFECT YOUR STATUTORY RIGHTS AS A CONSUMER.



9-10 Parsons Road, Parsons Industrial Estate, Washington Tyne & Wear, NE37 1HB, UK
0191 416 1717 or www.penn-elcom.com